

LÖWENSTEIN
medical

JOYCEclinic Full Face

Single-Patient-Use Mask

JOYCEclinic Full Face

No compromises.

With our **single-patient-use full-face mask** for acute non-invasive ventilation, you will experience the familiar quality from Löwenstein Medical.

JOYCEclinic Full Face allows **fast and simple mask fittings** and a **secure, comfortable fit** even at pressures of up to 50 hPa.

The headgear, which remains firmly in place even at high pressures, can be disconnected quickly and simply by pulling on the highly visible **quick-release cord**.

Single-patient-use mask prevents cross-contamination. In the hospital where cost pressure is high, you needn't make any compromises with patient safety.

- Prevention of cross-contamination
- Pressurestable mask cushion and headgear
- Quick-release cord

With four different, interchangeable elbow adapters, you'll find the right mask variant for every situation and device combination.

JOYCEclinic Full Face comes preassembled in three sizes in the variants **non-vented**, **non-vented with AAV** and **vented with AAV**. You can use the fitting template to make a good fit quickly and reliably. You don't even touch the mask, thanks to the two-chamber bag.

Available as a practical accessory, the **endoscope adapter** permits bronchoscopy without interrupting ventilation. The elbow adapters NV, NV+ AAV and Vented also are available as **replacement parts**.

All masks are available in sets of 10 without the two-chamber bag. Each set comes with Instructions for use and a fitting template.

- Three sizes
- Four interchangeable elbows
- Fitting template
- Two-chamber bag
- Single mask or set of 10 masks



Elbow Adapter

With the lever on the retaining ring, the elbow can be loosened easily and changed quickly at any time.



NV without AAV*



NV with AAV*



V with AAV*



Endoscope Adapter

Rotating Joint Adapter

A CPAP tube can be used with the help of the integrated rotating joint adapter in all vented variants.



Rotating Joint Adapter

*AAV = Anti-Asphyxia Valve

Which elbow should I use?

NV elbow

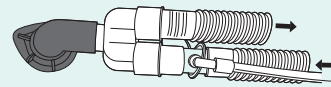

- Double Patient Circuit with separate inspiration and expiration and expiration valve at device end of tube

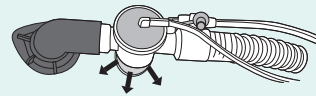

- Single Patient Circuit with expiration valve close to patient

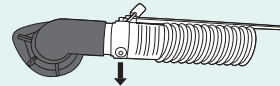

- Single Patient Circuit with CO₂ leakage

NV + AAV elbow

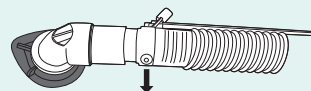

- Single Patient Circuit with CO₂ leakage and additional safety in event of device failure (Anti-Asphyxia Valve)
- Standard combination for ventilators with leakage system



- Single Patient Circuit with expiration valve close to patient may not be used.
- The flow is not high enough to hold open the anti-asphyxia valve.

Vented elbow

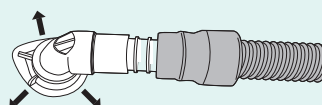

- Adapter and CPAP tube for use with prisma VENT or comparable ventilators

JOYCEclinic Full Face



Ordering information

Article one item per package	Article Number	Article 10 items per package	Article Number
JOYCEclinic Full Face NV • Size S • Size M • Size L	WM 26805 WM 26815 WM 26825	JOYCEclinic Full Face NV • Size S • Size M • Size L	WM 26857 WM 26858 WM 26859
JOYCEclinic Full Face NV + AAV • Size S • Size M • Size L	WM 26845 WM 26855 WM 26865	JOYCEclinic Full Face NV + AAV • Size S • Size M • Size L	WM 26869 WM 26870 WM 26871
JOYCEclinic Full Face vented • Size S • Size M • Size L	WM 26840 WM 26850 WM 26860	JOYCEclinic Full Face vented • Size S • Size M • Size L	WM 26866 WM 26867 WM 26868

Accessories

Endoscope Adapter	WM 15864
-------------------	----------

Replacement parts

NV Elbow	WM 25269	Headgear JOYCEclinic FF (5 pieces)	WM 26835
NV Elbow + AAV	WM 26834	Rotating joint Adapter*	WM 26916
Vented elbow	WM 26833		

* Rotating joint Adapter = included in the supply schedule for all vented variants

Technical data

Product class as per Directive 93 / 42 / EEC	IIa	Treatment pressure range	4 hPa - 50 hPa
Tube connection in accordance with EN ISO 5356-1	22 mm (female)	Geometric dead space Size S Size M Size L	225 ml 255 ml 305 ml

CE 0197

© Copyright protected. Reproduction of any type only with express permission from Löwenstein Medical.
We are not responsible for printing or typographical errors.



Löwenstein Medical Technology
Kronsaalsweg 40
22525 Hamburg, Germany
T. +49 40 54702-0
F. +49 40 54702-461
info@loewensteinmedical.com

Sales + Service
Löwenstein Medical
Arzbacher Straße 80
56130 Bad Ems, Germany
T. +49 2603 9600-0
F. +49 2603 9600-50
info@loewensteinmedical.com
loewensteinmedical.com

